

---

## Venue hire

Discover all the possibilities of this extraordinary hidden gem in London



With a heritage that dates back to 1348, and thrilling architecture and interiors that have witnessed significant moments in London's history, the Charterhouse is the ideal venue for an unforgettable event, and a stunning and authentic backdrop for films and photoshoots.

The almshouse established here in 1611 – still home to over 40 people today – gives the Charterhouse its unique atmosphere.

Situated by the ancient boundaries of the City of London, between Barbican and Farringdon, the seven-acre site consists of a series of buildings dating from the 14th century, many of which are Grade 1 listed. Originally a Carthusian monastery, the Charterhouse was then refashioned as a grand Tudor mansion. The school and almshouse founded here in the 17th century later saw many Victorian additions, with major renovation carried out by Seely & Paget after WW2.

More recently, striking new buildings and spaces have been sympathetically designed by Hopkins Architects and Eric Parry Architects.

We hope this guide inspires you to host your event in one of our many characterful spaces, all highly adaptable for different occasions and each memorably steeped in history. You will also be directly supporting this 400 year-old charity and the conservation of the site for future generations.

Due to the special nature of the Charterhouse community, events can only take place between 8.00am and 10.00pm.

- 4 The Great Hall
- 5 The Great Chamber
- 6 The Norfolk Cloister
- 7 The Governors' Room
- 8 The Charterhouse Chapel
- 9 The Chapel Cloister
- 10 The Old Library
- 11 Sutton Room
- 12 Master's Court
- 13 Washhouse Court
- 14 The Norfolk Garden
- 15 Charterhouse Square
- 16 Filming and creative hire
- 17 Suppliers and specialists
- 18 The Charterhouse floorplan
- 19 Contact

The Great Chamber



# Rooms and spaces The Great Hall

The original Tudor reception hall, which was presided over by nobles including Lord North, and the Duke of Norfolk.

A stunning and grand room, the Great Hall is perfect for formal dinners and receptions. Entertain your guests in the splendour of this historic hall, featuring a striking arched ceiling, magnificent windows, with a fine fireplace by Edmund Kinsman, a gallery and ornate carved wooden screen.

Capacity  
Reception 180  
Seated dinner 100  
Theatre 100

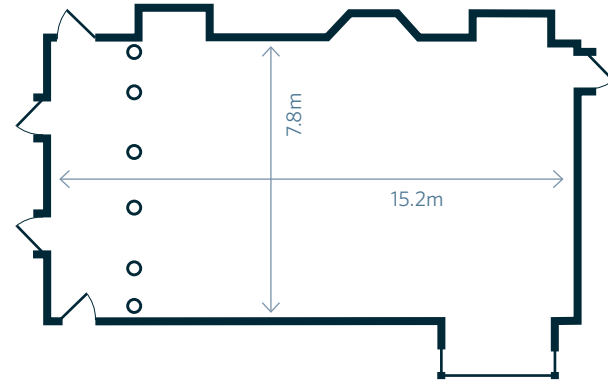

# The Great Chamber



Discover the extraordinary atmosphere of this very special room - the last surviving Tudor Great Chamber in London, where Elizabeth I prepared for her coronation and James I knighted his favoured noblemen.

With its ancient leaded lights, and impressive Jacobean fireplace, this is a grand and beautifully appointed space perfect for a dinner, party, concert or presentation.

Capacity  
Reception 180  
Seated dinner 120  
Theatre 140

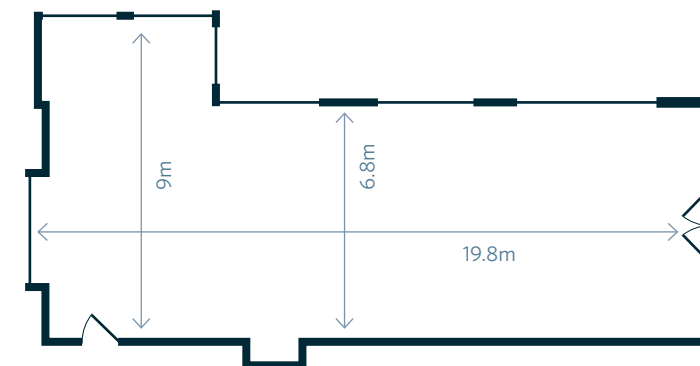

# The Norfolk Cloister

A stunning 14th century monastery cloister which, after the Reformation, was made into a garden gallery by the Duke of Norfolk. Much later, when the Charterhouse was still home to hundreds of schoolboys, this impressive space can lay claim to the creation of football's 'offside' rule.

A stone flag floor and original features which include an original doorway that lead to one of the original Carthusian monk's cells. With its serene atmosphere the cloister is ideal for corporate events, dinners and wine tastings.

### Capacity

Reception 180

Seated dinner 100

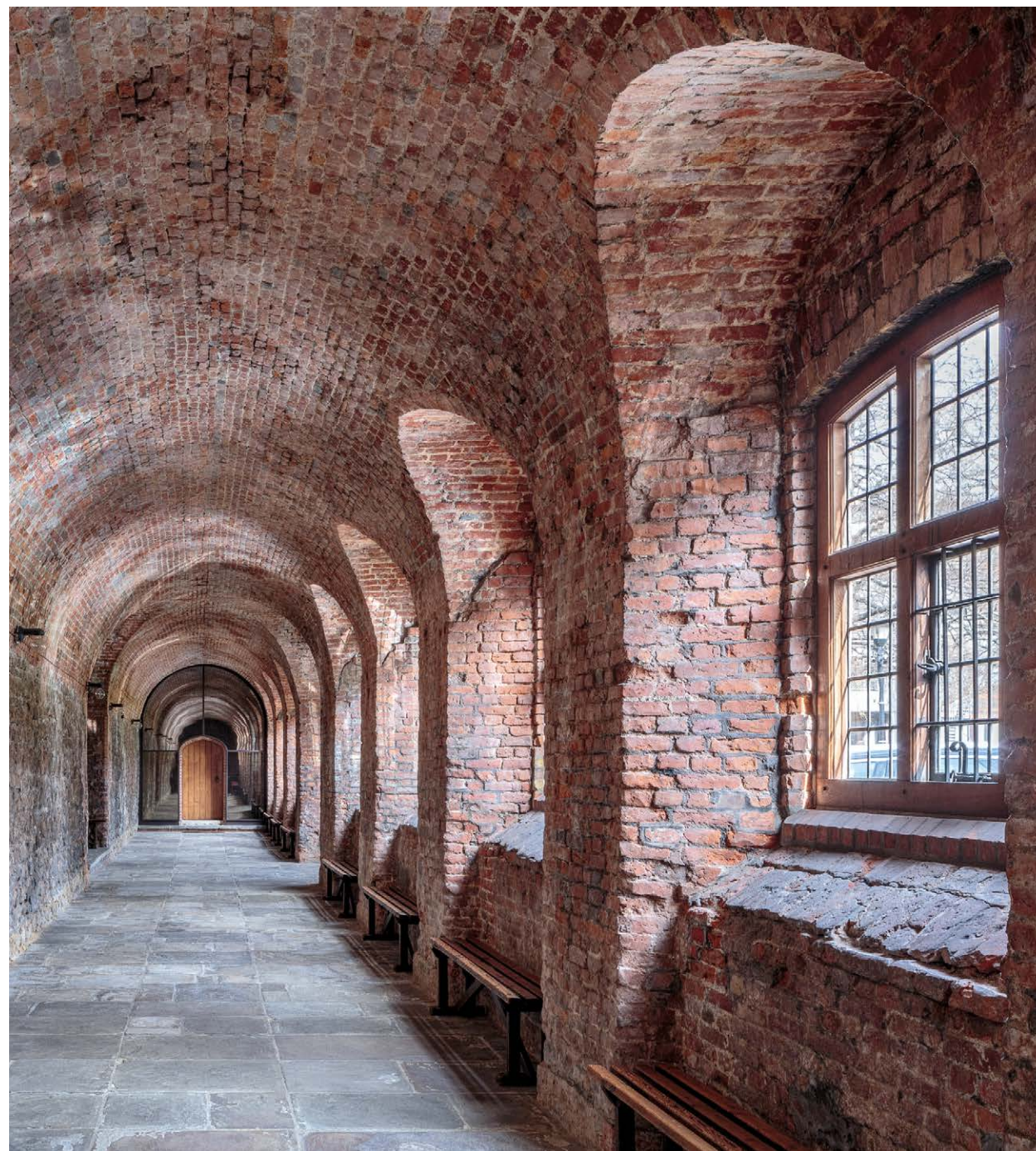
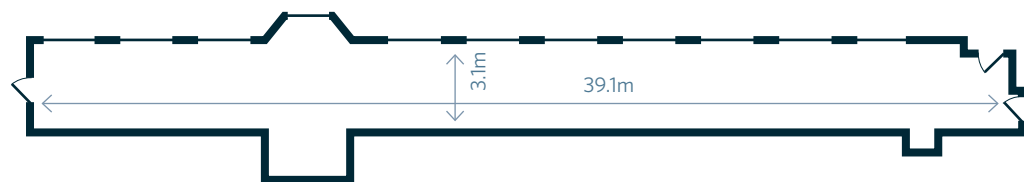

# The Governors' Room



This elegant room formed part of the original accommodation used by the Masters of the Charterhouse.

With painted wood panelling and prints of the Charterhouse adorning the walls, this space is an excellent setting for smaller gatherings - a smart and formal environment equally excellent for meetings and receptions. It can be used for breakout sessions from larger meetings.

*Capacity*  
Reception 50  
Seated 28  
Theatre 40

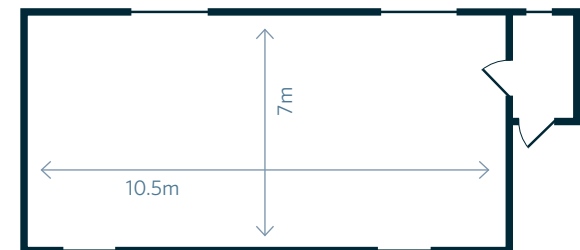

# The Charterhouse Chapel

This beautiful light-filled space was originally the Charterhouse of the monastery where monks met every week to discuss matters of the day.

It then became a fine example of a Jacobean chapel, later including the extraordinary memorial to the charity's founder Thomas Sutton.

With ornate wooden carving throughout, the chapel is full of historical architectural detail and has excellent acoustics. A fascinating and uplifting environment for concerts, talks, and special services.

Capacity  
Seated 140

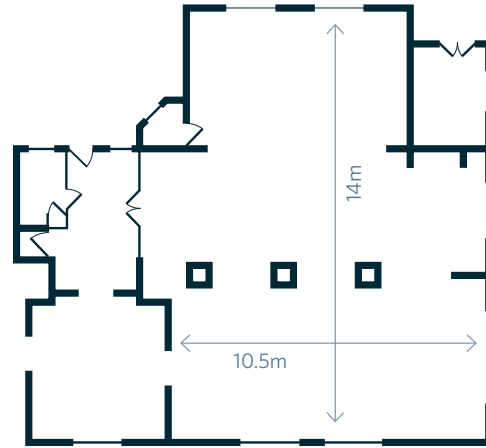

# The Chapel Cloister



The cloister leading into the Chapel is a wide airy space where you will find a variety of memorials to some of the early famous alumni of Charterhouse School and former Brothers of the almshouse.

With its stone flag floor, pale stone walls and lovely big arched windows looking out on to the Chapel garden and beyond to Charterhouse Square, this arcade lends itself beautifully to receptions and dinners.

Capacity  
Reception 60  
Seated dinner 40

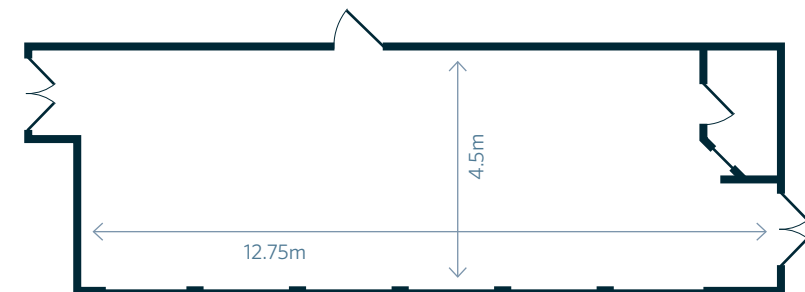

# The Old Library

Once Lord North's parlour chamber, then auditors' hall and afterwards the school dining room full of boisterous boys, the Old Library claimed its current title late in the 19th Century.

With its schoolboy graffiti, portraits of Governors through the decades, and scars from the WW2 blitz this is a room clearly telling stories of the Charterhouse's history. It is a dignified room, with stately fireplace and deep green walls ideal for both dinners and receptions.

## Capacity

Reception 120

Seated dinner 50

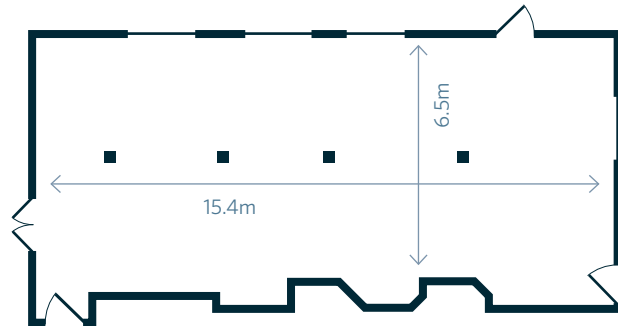



The Sutton Room is a modern light space designed as part of the Revealing the Charterhouse project, creating a welcoming and interactive interface between historic almshouse and visiting public.

Spot lighting based within octagonal ceiling coffers, representing an inversion of the stunning chapel ceiling, exemplifies the sympathetic way this new space has been designed to marry old and new. While this room is fully equipped for business meetings, lectures and presentations - it can be beautifully dressed for dining.

---

*Capacity*  
Reception 80  
Seated dinner 50  
Theatre 60

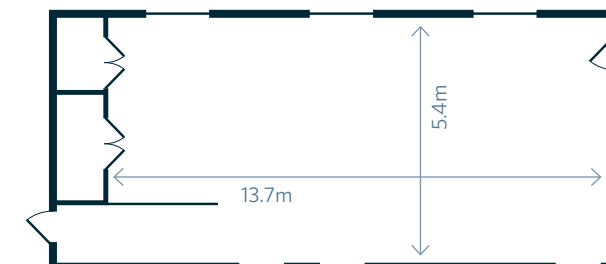

# Master's Court

Master's Court was the majestic approach to the Tudor Great Hall and then, after the charity was founded in 1611, the courtyard surrounded by rooms that were home to a series of Masters who had ultimate responsibility for the site.

A carefully maintained lawn with central lamppost is surrounded by a stone paved path with pretty planters around the edge of this imposing court. With its Tudor architecture, gilded Charles I crest, and distinctive Sutton sundial there are many features lending interest and atmosphere to this space. In the evening light glows from the tall windows, and candlelight and lanterns create a very special atmosphere – perfect for receiving guests, hosting receptions and setting the scene for your memorable event.

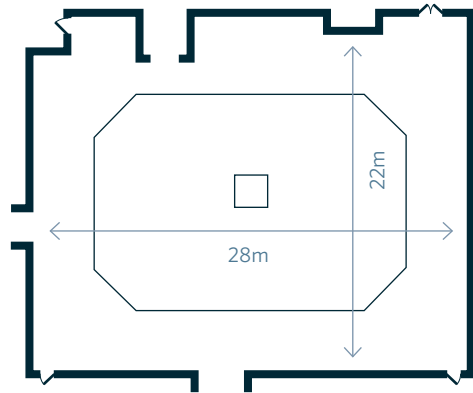

# Washhouse Court



One of the earliest parts of the Charterhouse, this would have been a bustling area servicing the monastery and then later the Tudor mansion - housing kitchens, bakery, workrooms and laundry.

The original cobbles, and extraordinary ancient buildings half of which are in monastic stone, and half in distinctive red and black Tudor brick, invite you to step back several centuries in this exceptionally lovely courtyard. This is a unique space for photoshoots, product launches, fashion events, filming and much more.

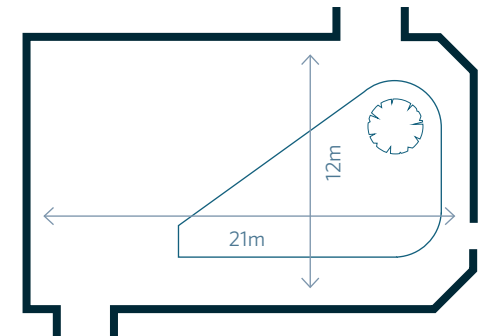

# The Norfolk Garden

This garden, running along the outside of the Norfolk Cloister, would have first been landscaped and planted in its present format after World War II.

Today it is a mature garden with a fine old cherry tree, designed as a haven for the almshouse residents.

Pretty and peaceful, this garden is delightfully laid out with secret corners and arbours and planted in the English Garden style, with flowering highpoints all year round. It is a lovely space for a reception, and a gorgeous floral backdrop for photoshoots and filming.

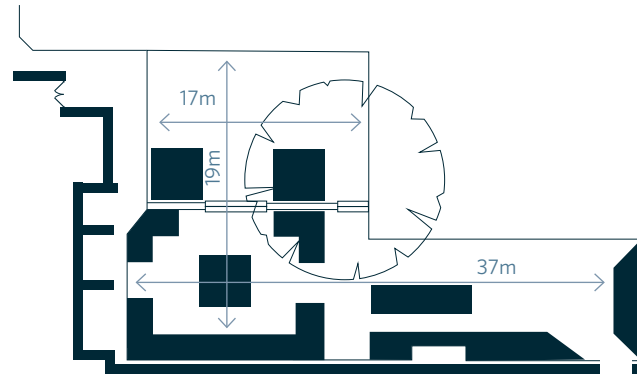



This Square in its key position on the edge of the City and between the ancient areas of Smithfield and Clerkenwell has played a prominent part of London's history from at least the mid 14th century.

It is only relatively recently that it has been lawned and planted, and become a peaceful 'urban oasis' for the enjoyment of the public during Charterhouse opening times.

This lovely privately-owned space with lawns, mature trees, wild meadow areas and planted beds is now surrounded by a mix of residential properties including both notable Georgian and Art Deco architecture, a school and some modern businesses. It is available to hire both exclusively and non-exclusively.



Whether you need a location that captures a specific period of history, or just a spectacular or atmospheric backdrop for a shoot, the Charterhouse will provide an excellent range of styles, architecture, light and authentic period detail.

The Charterhouse has both unique sections of a medieval monastery, and sumptuous rooms from when the site was a grand Tudor mansion where many noblemen lived, and where Elizabeth I first gathered her Privy Council before attending her coronation. Working either through a location agent, or directly with production companies, the site is a popular and effective location for a wide variety of films and TV series. These include St. Trinian's, Downton Abbey, Taboo, Little Dorrit, Tulip Fever and Misbehaviour.

We are also delighted to have hosted some stunning photoshoots for premier magazines, and lifestyle brands, including The Crown, GQ, Harper's Bazaar and Alexander McQueen.

We can accommodate largescale film crews, lighting rigs, and full equipment with parking space for production trucks.

While being conscious that the Charterhouse is an almshouse where older people in need still live, we can be flexible about schedules and filming times.





The team of professional Venue Hire managers here at the Charterhouse thrive on providing the best possible service.

However you imagine your event we are confident we can make it happen, and if you need inspiration, you'll find us full of creative and original ideas too. Our approved caterers are all of an excellent standard and are familiar working at the Charterhouse. They would be pleased to provide initial quotes.

We are also able to recommend a wide range of outside suppliers, production and AV specialists, to florists and entertainment, but we are of course happy to work with your own choices of suppliers if you prefer.

*Lettice Events*  
[www.letticeevents.com](http://www.letticeevents.com)  
[holly@letticeevents.com](mailto:holly@letticeevents.com)



# The Charterhouse floorplan

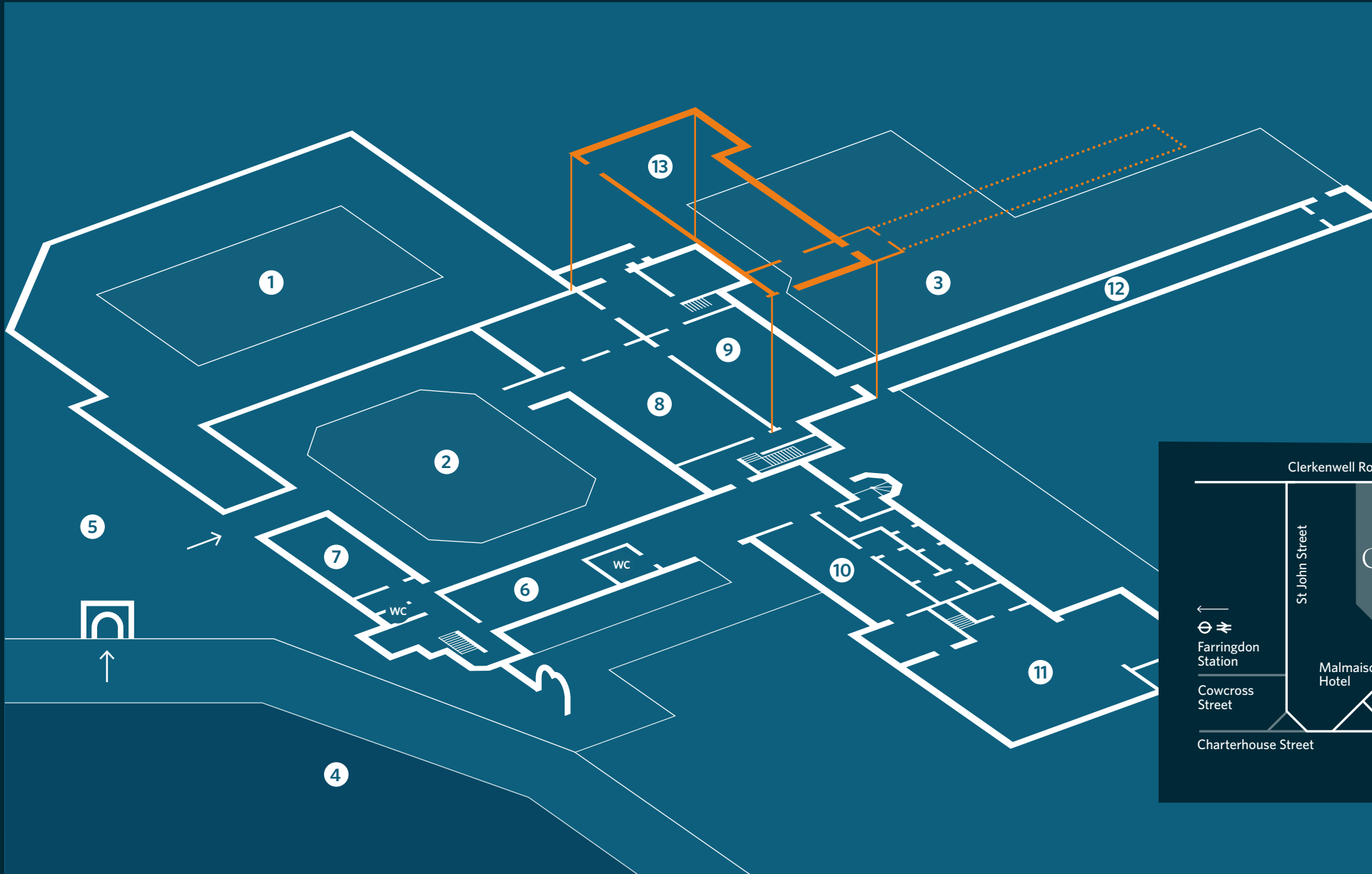

- 1 Washhouse Court
- 2 Master's Court
- 3 The Norfolk Garden
- 4 Charterhouse Square
- 5 Entrance Court
- 6 Sutton Room
- 7 The Governors' Room
- 8 The Great Hall
- 9 The Old Library
- 10 The Chapel Cloister
- 11 The Charterhouse Chapel
- 12 The Norfolk Cloister
- 13 The Great Chamber

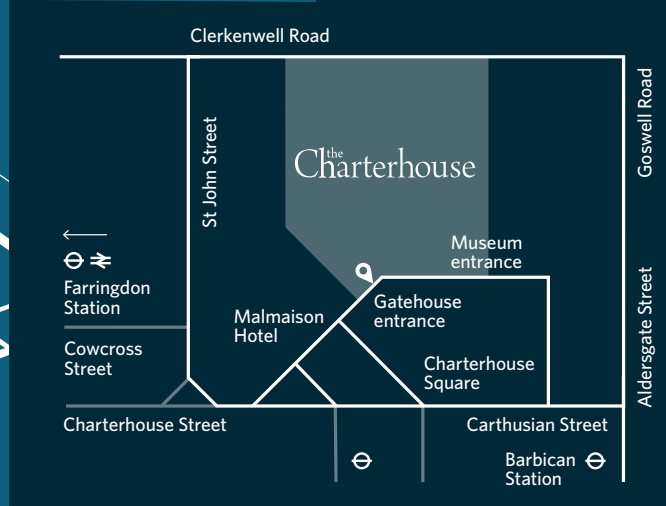

# Contact

The Charterhouse venue hire team are always willing to discuss your requirements and make suggestions that best suit your plans and budget

In the first instance it is very useful if you complete an enquiry form which you will find in the Venue Hire section of our website at [www.thecharterhouse.org](http://www.thecharterhouse.org)

To discuss your requirements, please contact the team

T 020 3817 4173  
[events@thecharterhouse.org](mailto:events@thecharterhouse.org)

The Charterhouse  
Charterhouse Square  
London  
EC1M 6AN

- 📍 @thecharterhouse\_events
- 📘 @thelondoncharterhouse
- 🐦 @charterhouseec1

Charity registered in England - No. 207773

