

# The Norfolk Garden



This garden, running along the outside of the Norfolk Cloister, would have first been landscaped and planted in its present format after World War II.

Today it is a mature garden with a fine old cherry tree, designed as a haven for the almshouse residents.

Pretty and peaceful, this garden is delightfully laid out with secret corners and arbours and planted in the English Garden style, with flowering highpoints all year round. It is a lovely space for a reception, and a gorgeous floral backdrop for photoshoots and filming.

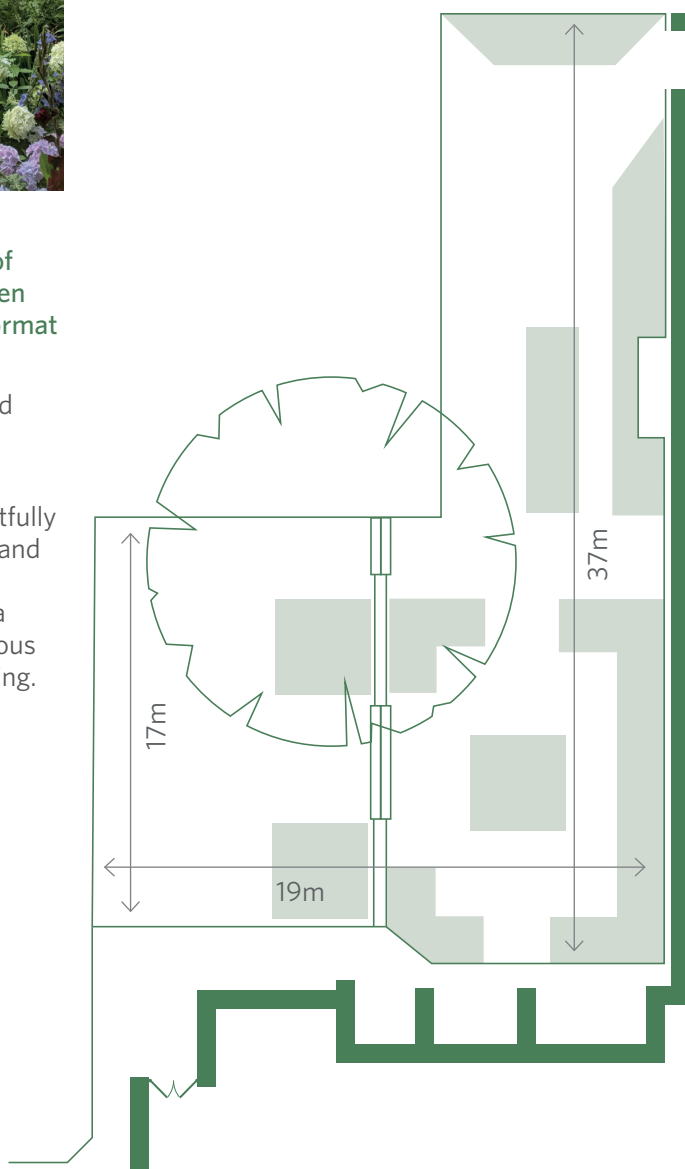

the  
Charterhouse

The Charterhouse  
Charterhouse Square  
London EC1 6AN  
[www.thecharterhouse.org](http://www.thecharterhouse.org)

Venue hire and film/photo location  
Contact our team:  
020 3817 4173  
[events@thecharterhouse.org](mailto:events@thecharterhouse.org)

Charity registered in England No. 207773

